



Locky 8015  
**Installation**  
Guide

# Table of Contents

**1** Parts

**2** Install the mortise

**3** Mount the solid bolt

**4** Put the lock on the door

**5** Put in the top screws

**6** Put in the bottom screws

**7** Connect the wire

**8** Add battery

**9** Put on back handle

# 1. Parts

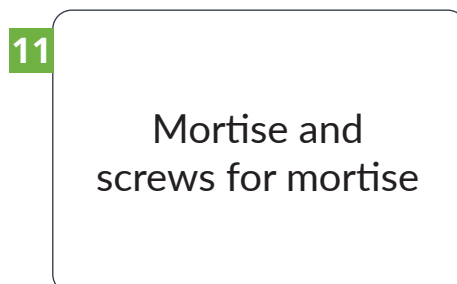
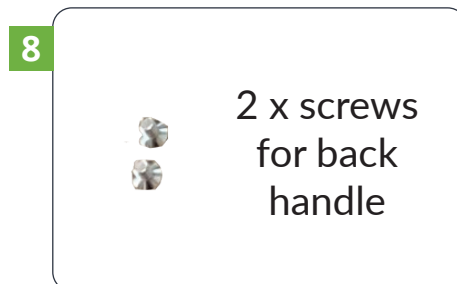
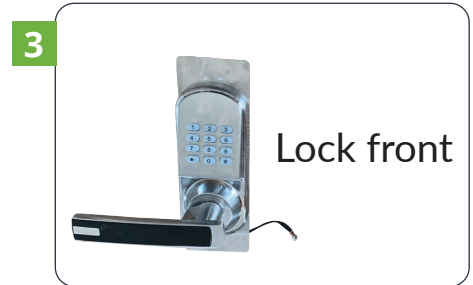
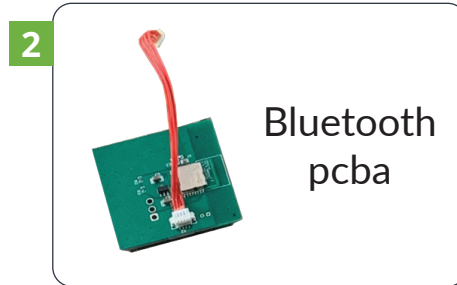

## 2. Install the mortise

First put the mortise into the door, then fasten it with the two screws.

## 3. Mount the solid bolt

**Warning: This is important, if failed to do so you risk the bolt to get out of position and the door won't be possible to open from the outside.**

Put the solid bolt (part number: 5) into the opening on the back side of the lock front (part number 3). Then fasten it using the clip (part number: 9) to make sure its fasten and wont loosen from the lock front.

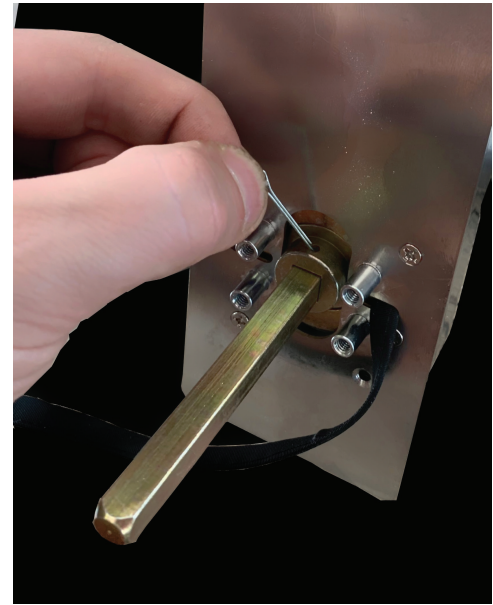

## 4. Put the lock on the door

Now start with sliding the front lock part (part number: 3) on to the door by pushing the solid bolt trough the mortise. Then put on the back lock part (part number: 1) by pushing the solid bolt on to the «lock back» part. This will free up your hands so you can start install the top screws on the lock. Please make sure the black wire fasten to the front lock (part 3) is all the way threaded all the way trough the door. And that the same wire is threaded trough the designated hole for the back lock part (part 1).



## 5. Insert in the top screws

Now measure the distance you need for the screws and cut them at the correct length. This is done by holding the screw up against the side of the door to measure them. Make sure they are long enough, if not the screw will not fit anymore. Because of this it is better to cut it a bit longer till begin with and adjust it by cutting more later on. Then screw the two screws into the two top holes located on top of the back lock part.

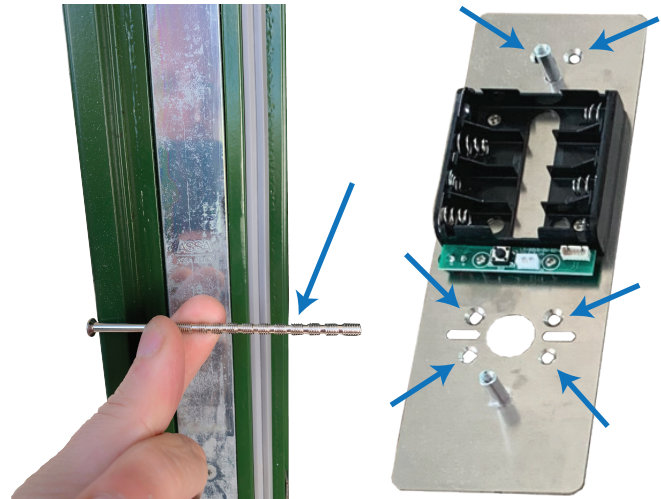

## 6. Put in the bottom screws

Cut the screws the same size as in step 5. Then depending on the door direction, install the screws in the correct holes at the bottom (diagonally). Left hinged doors has the top screw to the left top hole. The right hinged doors needs to install the screw in the top right side.

PS: Make sure the solid bolt (part number: 5) is as centered as possible when mounting the screws. This helps to avoid friction in the lock when opening the door.

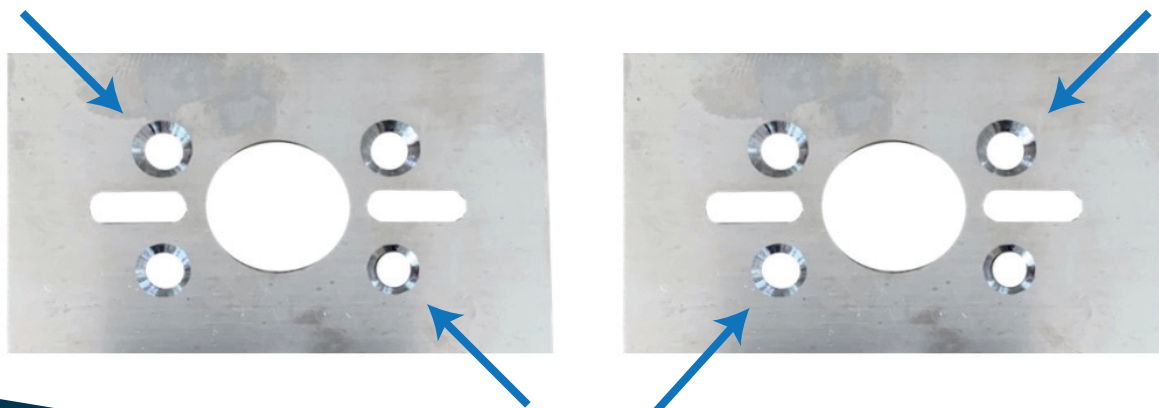

## 7. Connect the wire

Now connect the wire from the front pcba into the designed plug found under the battery slots.



## 8. Add battery

Now install the 4 AA batteries into the battery slots. To double check if the batteries were added properly, try pressing the panel in the front. It should make a sound when pressing a button.

## 9. Put on back handle

First thread the wire from the bluetooth pcba (partnumber : 2) through the back handle (part number : 4) and connect it to its designated input slot (below the battery slots). Now make sure the bluetooth pcba (partnumber 2) is connected to its plastic cap (part number: 6). Then mount the back handle by using the screw on top and bottom (partnumber: 8).

